

OLYMPUS[®]

Your Vision, Our Future

OLYMPUS
EndoTherapy
BEYOND THE SCOPE



Proceed With Confidence And Efficiency

A Revolutionary System That
Simplifies and Enhances
the Efficiency of
Therapeutic ERCP.



Long Recognized for its leadership and innovation in the development and manufacturing of gastrointestinal endoscopy products, Olympus has gained the confidence of physicians worldwide through its commitment to producing the most reliable and effective endoscopic products possible. As a total supplier of endoscopy products, we believe it is also our responsibility to provide physicians with devices that complement our endoscopes perfectly. We are proud to introduce the V-System — a revolutionary new line of ERCP endoscopes and integrated EndoTherapy accessories.

Innovative V-Groove Locks
And Holds The Guidewire
In Position for
Secure Device
Exchange



The V-System is a complete system that integrates Olympus endoscopes and EndoTherapy devices.

The revolutionary design simplifies and improves the efficiency of therapeutic ERCP.

With an array of unique features, the V-System offers the option of guidewire manipulation by the physician or the assistant.

It also allows for easier exchange of catheters.



Total confidence and maximum efficiency with enhanced device replacement and manipulation capability

Easy Device Exchange

1

Confirm the position of the V-Marking on the V-System EndoTherapy accessory



2

When the V-Marking is completely visible above the instrument channel port the guidewire may be locked in the V-Groove.



3

Completely remove the device leaving the guidewire in place.



Device Manipulation by the Physician or the Assistant

Now endoscopists have the option to manipulate the guidewire and devices

The convenient C-Hook allows the device handle to be attached to the V-Holder. With the device handle right at hand, the ability to maneuver the guidewire, inject contrast media, and manipulate the handle are possible — all while keeping a firm grip on the endoscope's control section.

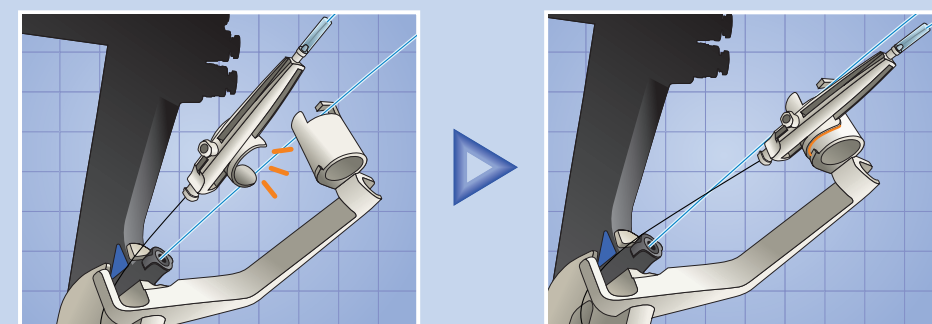

LinearGuideV is a unique guidewire specifically designed to optimize device manipulation to and from the bile and pancreatic ducts. When extended 130mm from the distal end of the scope, LinearGuideV may be locked in the V-Groove forceps elevator.

V-Marking
Indicates when to raise and lower the V-Groove forceps elevator.

C-Hook
Attaches device handle to the V-Holder, allowing you to maneuver the guidewire, inject contrast media, and manipulate the handle without letting go of the control section.

V-Sheath
Allows the option of control by either the physician or the assistant by allowing the guidewire sheath and injection sheath/handle to be separated.





Specifications, design and accessories are subject to change without any notice or obligation on the part of the manufacturer.

OLYMPUS®

www.olympus.com

OLYMPUS CORPORATION
Shinjuku Monolith, 3-1 Nishi-Shinjuku 2-chome, Shinjuku-ku, Tokyo 163-0914, Japan
OLYMPUS EUROPA GMBH
Postfach 10 49 08, 20034 Hamburg / Wendenstrasse 14-18, 20097 Hamburg, Germany
OLYMPUS AMERICA INC.
2 Corporate Center Drive, Melville, N.Y. 11747-3157, U.S.A.
OLYMPUS LATIN AMERICA, INC.
6100 Blue Lagoon Drive, Suite 390 Miami, Florida 33126-2087, U.S.A
KEYMED LTD.
Keymed House, Stock Road, Southend-on-Sea, Essex SS2 5QH, England

OLYMPUS SINGAPORE PTE LTD.
491B River Valley Road #12-01/04, Valley Point Office Tower, Singapore 248373
OLYMPUS HONG KONG AND CHINA LIMITED
Room 1520-1527, Ocean Centre, 5 Canton Road, Tsimshatsui, Kowloon, Hong Kong
OLYMPUS BEIJING REPRESENTATIVE OFFICE
Room 1401, East Tower, Gong Yuan No6 Royal Palace, No6 Gong YuanXijie, JianGuoMenNei, DongCheng District, Beijing, 100005, China
OLYMPUS MOSCOW LIMITED LIABILITY COMPANY
117071, Moscow, Malaya Kaluzhskaya 19, bld. 1, fl.2, Russia
OLYMPUS AUSTRALIA PTY LTD.
31 Gilby Road, Mount Waverley, VIC., 3149, Australia

Printed in Japan F1078SB-4-0904